

The SPECTRUM SERIES wired WiFi clocks eliminate the need for batteries when a reliable power source is available. The Spectrum wired WiFi clock can simply plug into an available electrical outlet or leverage aging clock system wiring as a power source. Master clock systems are sometimes difficult to maintain if the type of replacement clock is unknown or obsolete. This Spectrum clock can be powered by the existing wiring making clock replacements easy.

**WiFi Network Connection.** Rather than creating a radio frequency spectrum competing RF system of transmitters and repeaters with unpredictable results, WiFi based clocks leverage your initial or previous investment in your building's existing network infrastructure. This WiFi based system allows technicians and support staff to use familiar diagnostic tools, equipment and training that proprietary RF systems don't offer. National's clocks connect to 802.11b/g/n WiFi using WPA, WPA2, and open networks. They support DHCP to ease setup effort and utilize SNTP services for time accuracy.

**Monitoring Capabilities.** Unlike most RF battery systems and competing WiFi clocks, National's WiFi connection provides two-way communication. Not only can the connection status to the time service be monitored, so can the WiFi signal level, time synchronization check-in history and other settings. National's exclusive TIMEWISE™ Cloud Service provides these statistics to any PC or hand-held device with an internet connection. Take control and be proactive with your time system rather than wait for complaints from occupants that the clock is off time.

**Easy Setup.** National Time has developed the WiFi Wizard setup interface. Using only a web browser on any WiFi enabled device, the user is led step-by-step through the fast setup process. Alternately, there are also android and iOS apps available. These apps will scan for nearby clocks, automatically download required settings, and verify connection to the selected SNTP time server.

Each clock is made of durable ABS plastic with shatterproof Polycarbonate lens and a white polystyrene dial having black markings and hands. Cases are available in Grey or Black. Metal cases are also available, refer to Bulletin C-579.



## Benefits:

- Easily synchronize with NIST or other SNTP servers
- Supports 802.11b/g/n WiFi networks
- Leverage existing clock system wiring or 120V outlet
- Industry's easiest WiFi Wizard setup
- RappID™ Android and iOS phone apps
- TIMEWISE™ Cloud monitors connection and vitals
- Long, wide hands offer increased visibility
- Made in USA

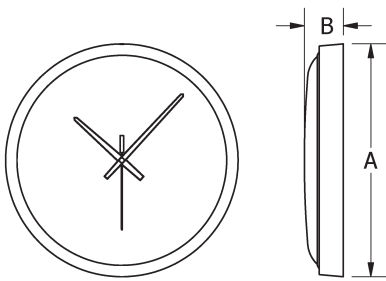

ABS Plastic Case with Polycarbonate Lens

Dial Size	A	B
12" Round Plastic - Surface	13.35"	2.28"

### Optional Accessories:

Part No.	Description
1504-LT	Surface Mounting Bracket Less Terminal Block
143	Flush Mount Wall Box
SRP-12ADAPT-NF	Hanger Bracket for National 143 Wall Box
12WGS	Wire Guard for 12" Round Clocks

### Specifications:

**Network:** 802.11b/g/n; DHCP; SNTP; WPA; WPA2; Open

**Power:** Version **(-24V)** 27mA@24VAC (16-28VAC); 17mA@24VDC (15-35VDC)  
**(-120V-HW)** 20mA@120VAC (108-132VAC)

Standard Mounting with appropriate wall anchor for wall type. Add a hole in wall for wire entry. (-24V Only)

Mounting to Single Gang or Handy Box with 1504-LT bracket. (-24V shown)

Mounting to Single Gang or Handy Box with 1504-LT bracket. (-HW shown) Transformer mounts inside electrical box

Mounting to existing National Time 143 Flush Mount Clock box with optional SRP-12ADAPT-NF bracket.

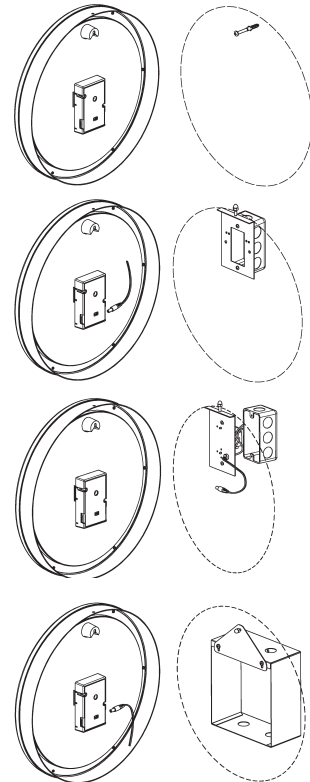

## Ordering Information

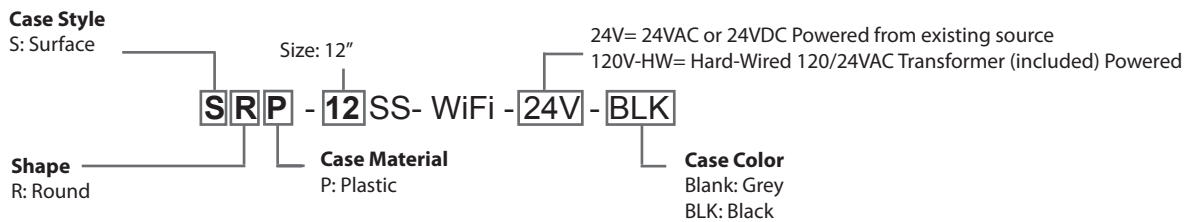

### Popular Part number examples:

Model Number	Description
SRP-12SS-WIFI-24V	Plastic Surface Round 12";24V Powered WiFi Clock - Grey
SRP-12SS-WIFI-24V-BLK	Plastic Surface Round 12";24V Powered WiFi Clock - Black
SRP-12SS-WIFI-120V-HW	Plastic Surface Round 12" WiFi Clock, w 120/24V Hard-Wire Transformer - Grey
SRP-12SS-WIFI-120V-HW-BLK	Plastic Surface Round 12" WiFi Clock, w 120/24V Hard-Wire Transformer - Black